

| | | | | |
|--|--|--|-------------------------|---------------------------------|
| PLAN OF SUBDIVISION | | EDITION 1 | PS840871F | |
| LOCATION OF LAND PARISH: Shepparton TOWNSHIP: SECTION: CROWN ALLOTMENT: 97(Part) CROWN PORTION: TITLE REFERENCE: C/T VOL 12227 FOL 012 LAST PLAN REFERENCE: Lot A PS823647H POSTAL ADDRESS: Harvard Drive (at time of subdivision) Shepparton North 3631 MGA94 CO-ORDINATES: E: 356 825 ZONE: 55 (of approx centre of land in plan) N: 5 978 430 | | Council Name: Greater Shepparton City Council SPEAR Reference Number: S167497S | | |
| VESTING OF ROADS AND/OR RESERVES | | NOTATIONS | | |
| IDENTIFIER | COUNCIL / BODY / PERSON | Lots 1 to 65 (all inclusive) have been omitted from this plan. <u>Other purpose of this plan</u> To remove by agreement that part of Easement E-1 created in PS807293J that now lies within Reserve No 1 and Harvard Drive on this plan under the powers of Section 6(1)(k) of the Subdivision Act 1988. | | |
| ROAD R-1 RESERVE No 1 | Greater Shepparton City Council Greater Shepparton City Council | | | |
| NOTATIONS | | | | |
| DEPTH LIMITATION : 15.24 metres | | | | |
| SURVEY: This plan is based on survey STAGING: This is not a staged subdivision Planning Permit No 2017-81 This survey has been connected to permanent marks No(s) 11, 12, 260, 1064, 1065, 1066, 1067, 1068, 1091 & 1092 In Proclaimed Survey Area No | | | | |
| EASEMENT INFORMATION | | | | |
| LEGEND: A - Appurtenant Easement E - Encumbering Easement R - Encumbering Easement (Road) | | | | |
| Easement Reference | Purpose | Width (Metres) | Origin | Land Benefited / In Favour of |
| E-1 | Drainage | 2m | PS807293J | Greater Shepparton City Council |
| Providence Estate Stage 4 (7 Lots) | | | AREA OF STAGE - 3.135ha | |
|  144 Welsford Street PO Box 926 Shepparton Vic 3632 T 61 3 5849 1000 spiire.com.au | | SURVEYORS FILE REF: 308434SV00 | | ORIGINAL SHEET SIZE: A3 |
| | | Digitally signed by: Michael John Meehan, Licensed Surveyor, Surveyor's Plan Version (1), 26/11/2020, SPEAR Ref: S167497S | | SHEET 1 OF 2 |

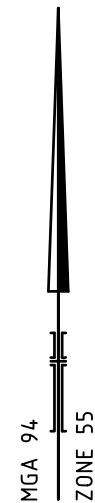

SURVEYOR'S FILE REF: 308434SV00

SCALE
1: 1000

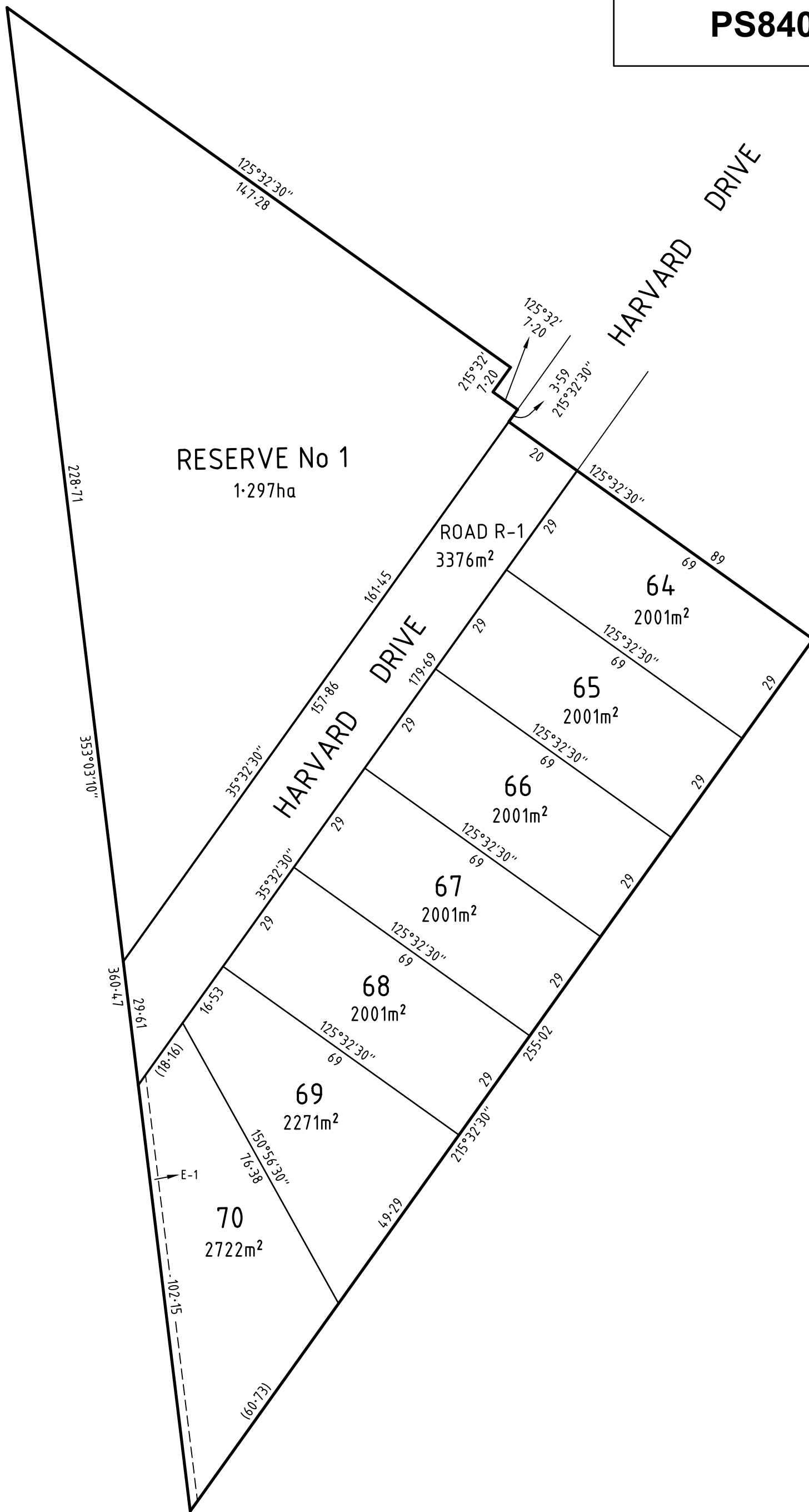
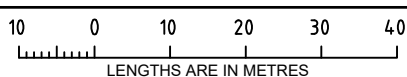

ORIGINAL SHEET
SIZE: A3

SHEET 2



144 Welsford Street
PO Box 926
Shepparton Vic 3632
T 61 3 5849 1000
spiire.com.au

Digitally signed by: Michael John Meehan, Licensed Surveyor,
Surveyor's Plan Version (1),
26/11/2020, SPEAR Ref: S167497S