

# APPENDIX C

## PLAN OF SUBDIVISION

<b>PLAN OF SUBDIVISION</b>		EDITION 1	<b>PS823650U</b>	
<b>LOCATION OF LAND</b> PARISH: KIALLA TOWNSHIP: SECTION: CROWN ALLOTMENT: 70A (PART) CROWN PORTION: - TITLE REFERENCE: C/T VOL 11905 FOL 043 VOL 12158 FOL 511  LAST PLAN REFERENCE: LOT D PS742402Q LOT 2 PS701822X  POSTAL ADDRESS: 582 ARCHER ROAD (at time of subdivision) KIALLA 3631  MGA94 CO-ORDINATES:     E: 357 070             ZONE: 55 (of approx centre of land in plan)     N: 5 966 765		Council Name: Greater Shepparton City Council  SPEAR Reference Number: S152461J		
<b>VESTING OF ROADS AND/OR RESERVES</b>		<b>NOTATIONS</b>		
IDENTIFIER	COUNCIL / BODY / PERSON		Further purpose of plan:  Removal of that part of the Gas Transmission Pipeline Easement created in C/E G1244 where now contained in ROAD R-2 Grounds for removal: Consent of Vic Gas Distribution Pty Ltd	
ROAD R-1 ROAD R-2	GREATER SHEPPARTON CITY COUNCIL GREATER SHEPPARTON CITY COUNCIL			
<b>NOTATIONS</b>		Removal of Electricity Supply Easement created on LP112600 Grounds for Removal: Planning Permit No 2012-297 issued by Greater Shepparton City Council		
DEPTH LIMITATION DOES NOT APPLY				
<b>SURVEY:</b> This plan is based on survey  <b>STAGING:</b> This is not a staged subdivision Planning Permit No. 2011-11  This survey has been connected to permanent marks No(s).  In Proclaimed Survey Area No.				
<b>EASEMENT INFORMATION</b>				
LEGEND: A - Appurtenant Easement    E - Encumbering Easement    R - Encumbering Easement (Road)				
Easement Reference	Purpose	Width (Metres)	Origin	Land Benefited / In Favour of
E-1	Pipelines or Ancillary Purposes	2.50	PS701821A - Sec 36 Water Act 1989	Goulburn valley Region Water Corporation
E-2, E-3 & E-4	Water Supply & Drainage	See Diag	C/E 1324813	State Rivers & Water Supply Commission
E-3	Power Line	10.98	PS742402Q - Sec 88 Electricity Industry Act 2000	Powercor Australia Ltd
E-4	Gas Transmission Pipeline	4.61	C/E G1244	Gas & Fuel Corporation of Victoria
E-5	Water Supply & Drainage	2.01	C/E C6016	State Rivers & Water Supply Commission
E-6	Pipelines or Ancillary Purposes	2.50	PS731253S - Sec 136 Water Act 1989	Goulburn Valley Region Water Corporation
E-7	Pipelines or Ancillary Purposes	2.50	PS742402Q - Sec 136 Water Act 1989	Goulburn Valley Region Water Corporation
E-8	Pipelines or Ancillary Purposes	2.50	This Plan - Sec 136 Water Act 1989	Goulburn Valley Region Water Corporation
E-9	Carriageway	Se Diagram	This Plan	Greater Shepparton City Council
<b>SANCTUARY PARK ESTATE - STAGE 5 (24 LOTS)</b>			<b>AREA OF STAGE - 2.611ha</b>	
144 Welsford Street PO Box 926 Shepparton Vic 3632 T 61 3 5849 1000 spiire.com.au		SURVEYORS FILE REF: 306644SV00		ORIGINAL SHEET SIZE: A3
		SHEET 1 OF 3		
		Digitally signed by: Michael John Meehan, Licensed Surveyor, Surveyor's Plan Version (3), 06/05/2020, SPEAR Ref: S152461J		

PS823650U

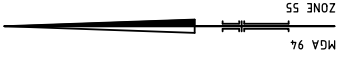

ARCHER ROAD

WILGARNING DRIVE

REEVE STREET

WILGARNING DRIVE

MALMSBURY CRESCENT

WILGARNING DRIVE

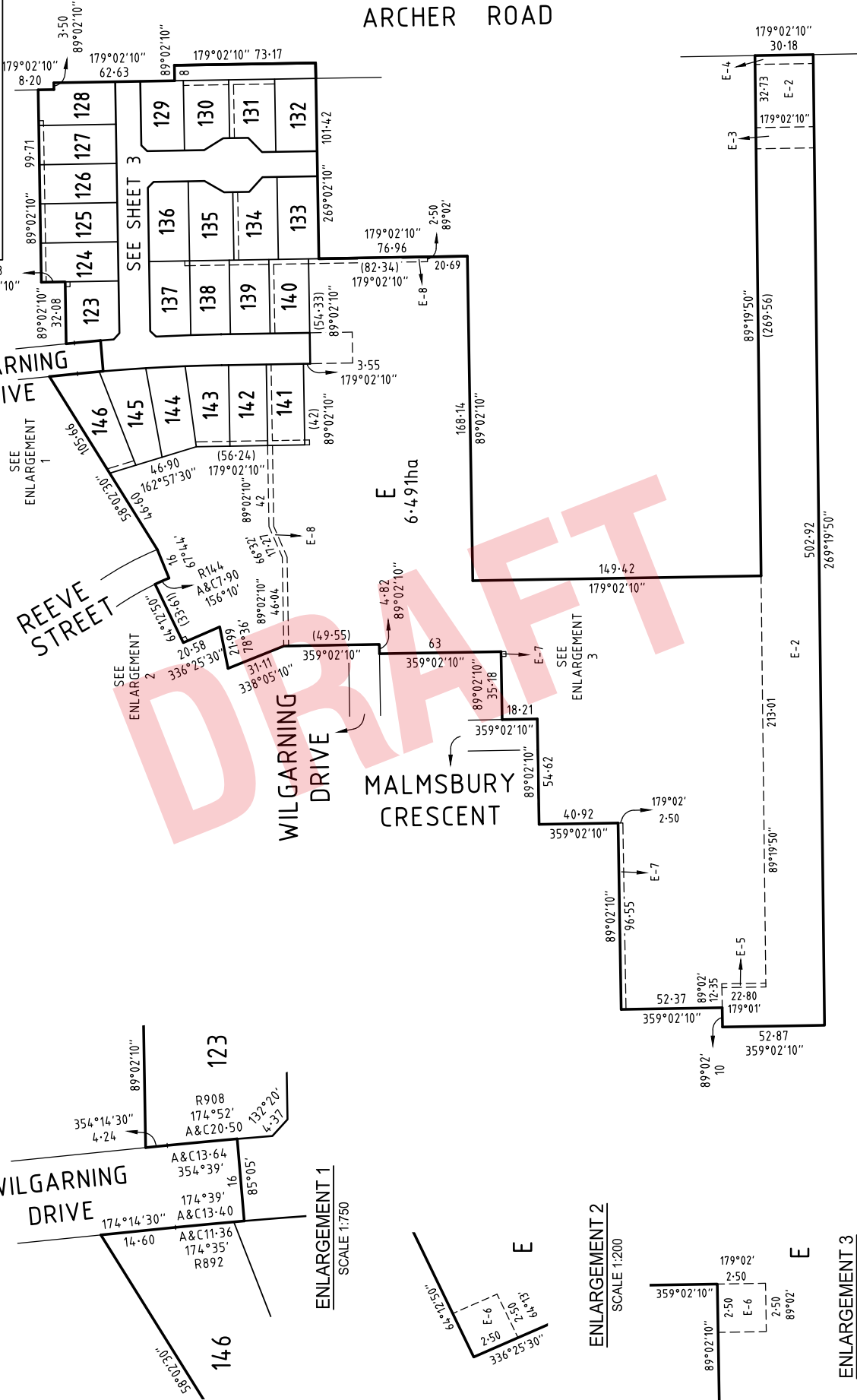

E 6.491ha

ENLARGEMENT 1  
SCALE 1:750

ENLARGEMENT 2  
SCALE 1:200

ENLARGEMENT 3  
SCALE 1:200

SHEET 2

ORIGINAL SHEET  
SIZE: A3

SCALE  
1: 2000

Digitally signed by: Michael John Meehan, Licensed Surveyor, Surveyor's Plan Version (3), 06/05/2020, SPEAR Ref: S152461J

SURVEYOR'S FILE REF: 306644SV00

144 Welford Street  
PO Box 926  
Shepparton Vic 3632  
T 61 3 9849 1000  
spire.com.au



PS823650U



ARCHER ROAD

ROAD R-2  
585m<sup>2</sup>

COLEMAN CLOSE

AVON STREET

ROAD R-1  
5332m<sup>2</sup>

WILGARNING DRIVE

WILGARNING DRIVE

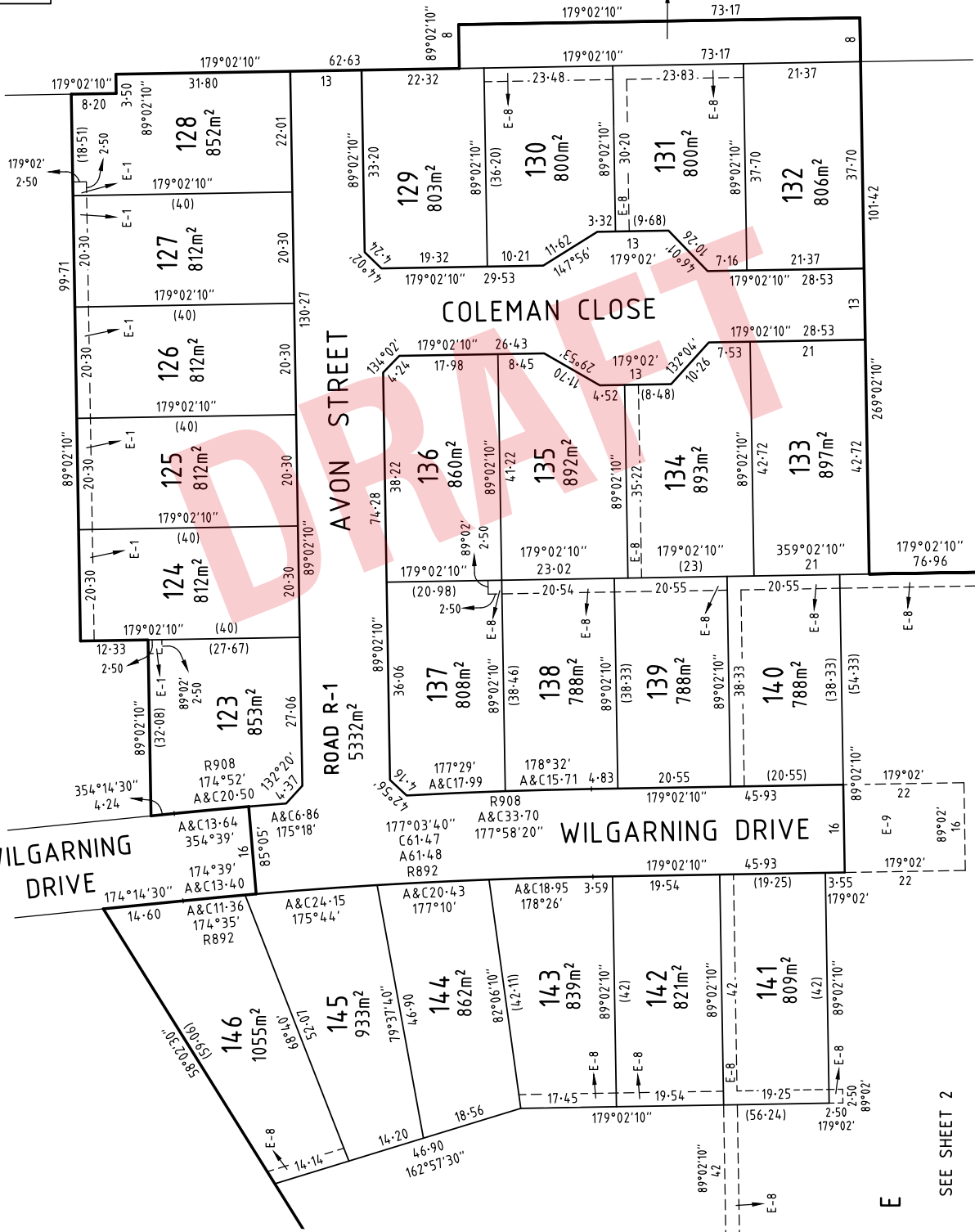

E

SEE SHEET 2

SURVEYOR'S FILE REF: 306644SV00	144 Weisford Street PO Box 826 Shepparton Vic 3632 T 61 3 5849 1000 spire.com.au	<p><b>spire</b></p>
	<p>Digitally signed by: Michael John Meehan, Licensed Surveyor, Surveyor's Plan Version (3), 06/05/2020, SPEAR Ref: S152461J</p>	
SCALE 1: 750	<p>7.5 0 7.5 15 22.5 30</p> <p>LENGTHS ARE IN METRES</p>	ORIGINAL SHEET SIZE: A3
		SHEET 3