

PLAN OF SUBDIVISION			EDITION 1	PS849455W
LOCATION OF LAND PARISH: KIALLA TOWNSHIP: - SECTION: - CROWN ALLOTMENT: 77C (PART) CROWN PORTION: - TITLE REFERENCE: C/T VOL FOL ... LAST PLAN REFERENCE: PS840865A, LOT A POSTAL ADDRESS: 7815 GOULBURN VALLEY HIGHWAY (at time of subdivision) KIALLA 3631 MGA2020 CO-ORDINATES: E: 355 315 ZONE: 55 (of approx centre of land in plan) N: 5 967 410				
VESTING OF ROADS AND/OR RESERVES			NOTATIONS	
IDENTIFIER	COUNCIL / BODY / PERSON		Land being subdivided is enclosed within thick continuous lines Lots 1 to 31 and A (all inclusive) have been omitted from this plan. <u>Other purpose of this plan</u> To remove by agreement Carriageway Purposes Easement created in PS840865A that lies within this plan via section 6 (1) (k) of the Subdivision Act 1988.	
ROAD R-1	GREATER SHEPPARTON CITY COUNCIL			
RESERVE No. 1	POWERCOR AUSTRALIA LTD			
RESERVE No. 2	POWERCOR AUSTRALIA LTD			
NOTATIONS				
DEPTH LIMITATION : DOES NOT APPLY				
SURVEY: This plan is based on survey in PS823661P STAGING: This is not a staged subdivision Planning Permit No. 2020-18 This survey has been connected to permanent marks No(s). 81, 113, 114, 338 340, 359 In Proclaimed Survey Area No. -				
EASEMENT INFORMATION				
LEGEND: A - Appurtenant Easement E - Encumbering Easement R - Encumbering Easement (Road)				
Easement Reference	Purpose	Width (Metres)	Origin	Land Benefited / In Favour of
E-1	PIPELINES OR ANCILLARY PURPOSES	2.5	PS840865A (SEC 136 WATER ACT 1989)	GOULBURN VALLEY REGION WATER CORPORATION
E-2	PIPELINES OR ANCILLARY PURPOSES	2.5	THIS PLAN (SEC 136 WATER ACT 1989)	GOULBURN VALLEY REGION WATER CORPORATION
SEVEN CREEKS ESTATE - STAGE 19 (24 LOTS)				AREA OF STAGE - 3.061ha
 144 Welsford Street PO Box 926 Shepparton Vic 3632 T 61 3 5849 1000 spiire.com.au		SURVEYORS FILE REF: 308568SV00 Licensed Surveyor: Mark Christopher Sargent Version: 1	ORIGINAL SHEET SIZE: A3	SHEET 1 OF 2

DRAFT

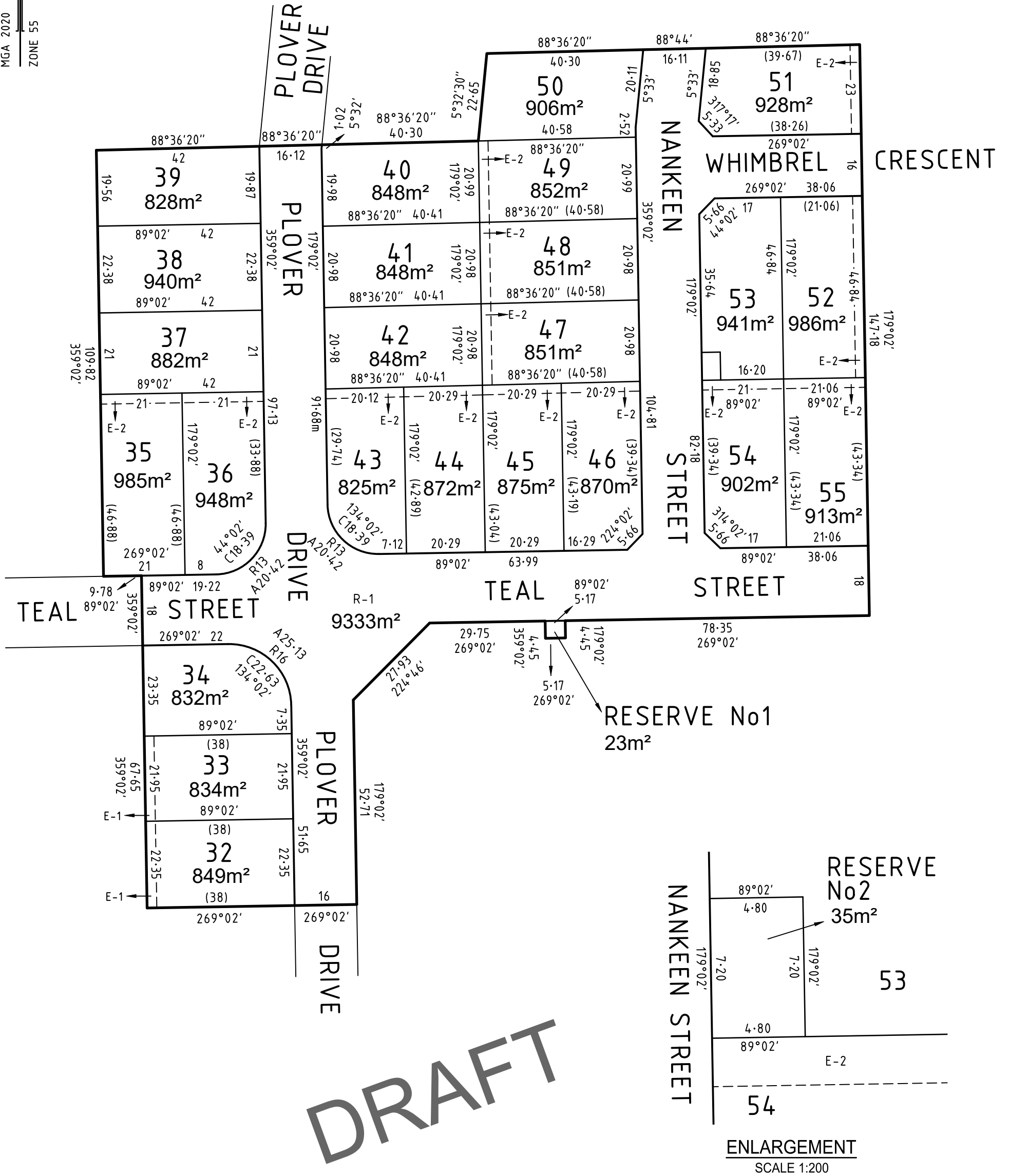

DRAFT

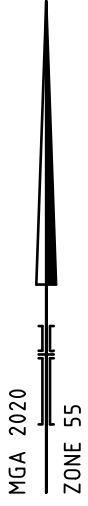